

# Tulsa County

Tulsa County Courthouse Space Needs Study Visioning Session  
September 20, 2023



Carol Salzman, World Atlas





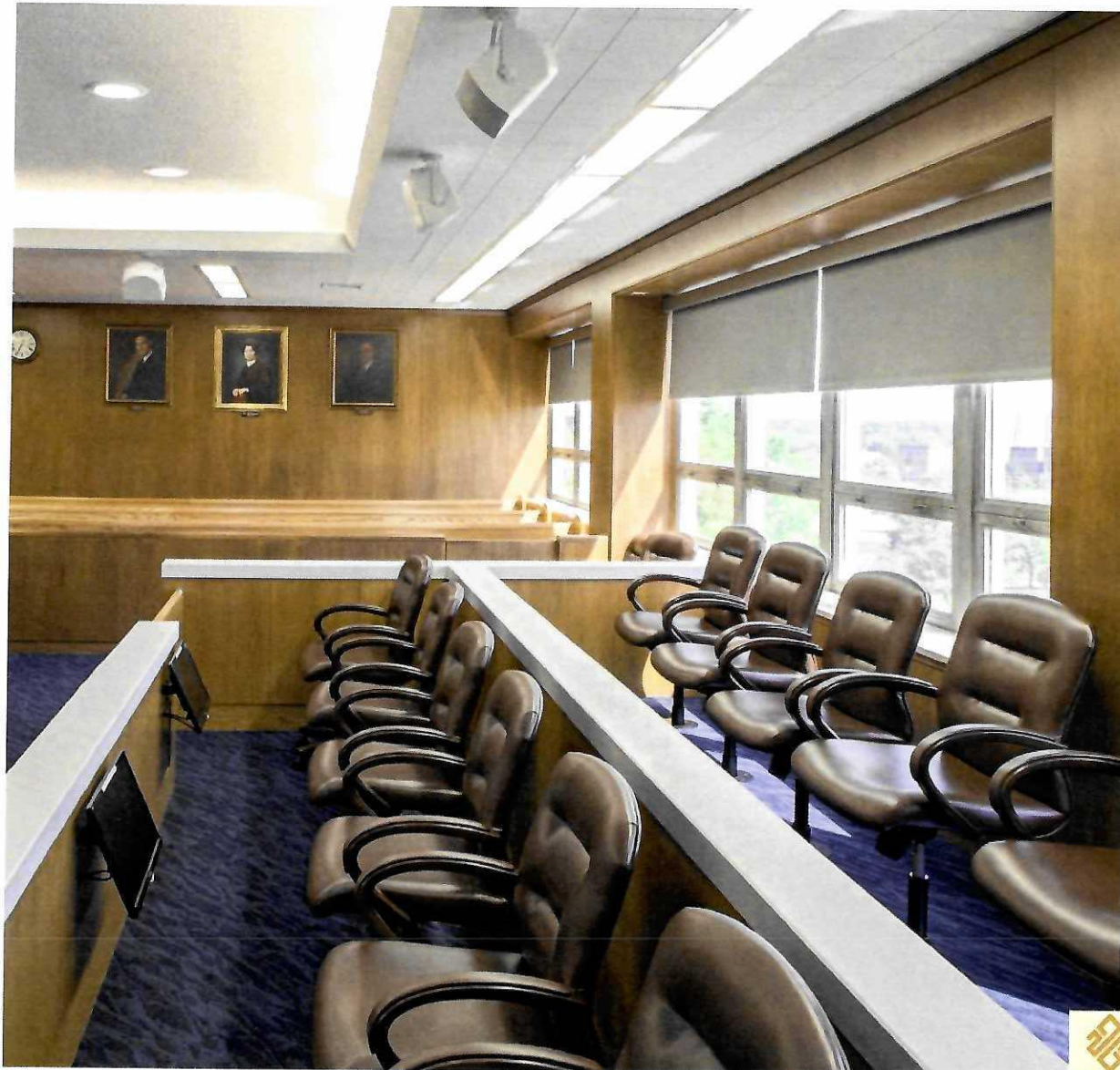

# Agenda

- Space Program
- Projections
- Master Plan
- Next Steps

# Your Team



Jeff Lane  
Principal Justice Architect



Tim Dibble  
Senior Analyst

## TreanorHL:

- Over 20 Years of Justice Experience
- Courthouse Functions
- Planning and design leadership

## JMI:

- Over 30 Years of Justice Experience
- Space programming
- Development alternatives



# Goal

Tulsa County is seeking a comprehensive study on the usage and optimization of its existing judicial facilities and a space plan based on 20-year projections of need. The goal includes the need for creative approaches to address short- and long-term needs, up to 75 years.

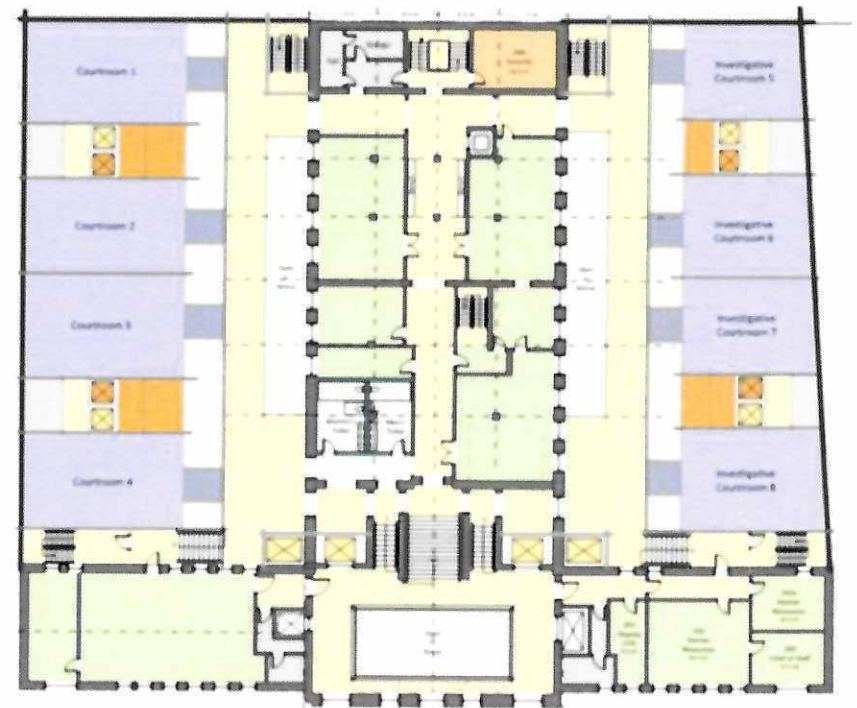



# Objectives

- Provide an overview space program.
- Review and assess off-site buildings for use of courthouse functions and related County functions.
- Develop and present concept ideas for short term and long-term build-out.
- Evaluate block and stack diagrams for concept ideas.
- Submit a final report including space program, concept ideas, and diagrams, comparing with the Tulsa County Master Plan

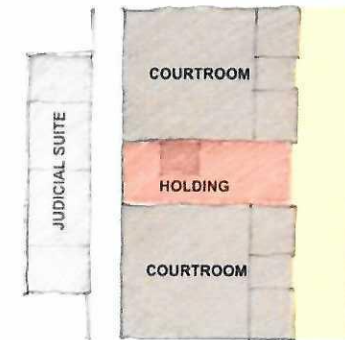
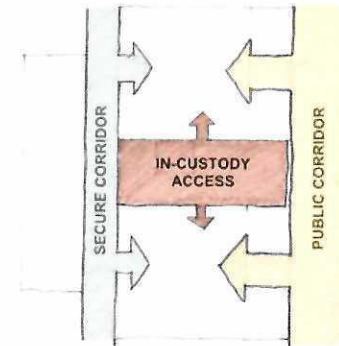

# Phase 1 – Space Program

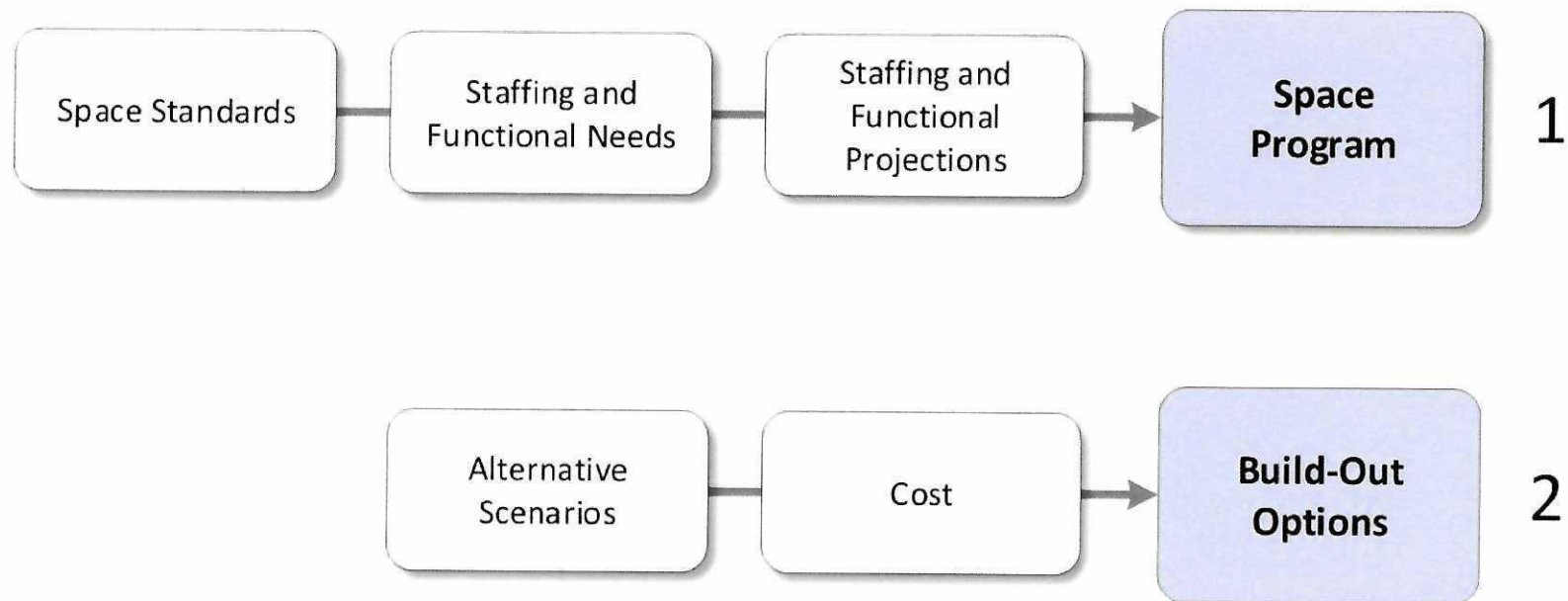

# Phase 1 – Space Program

- A space program is not a design.
- Build-out options are subject to change and modifications.
- Costs are subject to revenue and inflation, among other factors.

# Staffing and Functional Projections

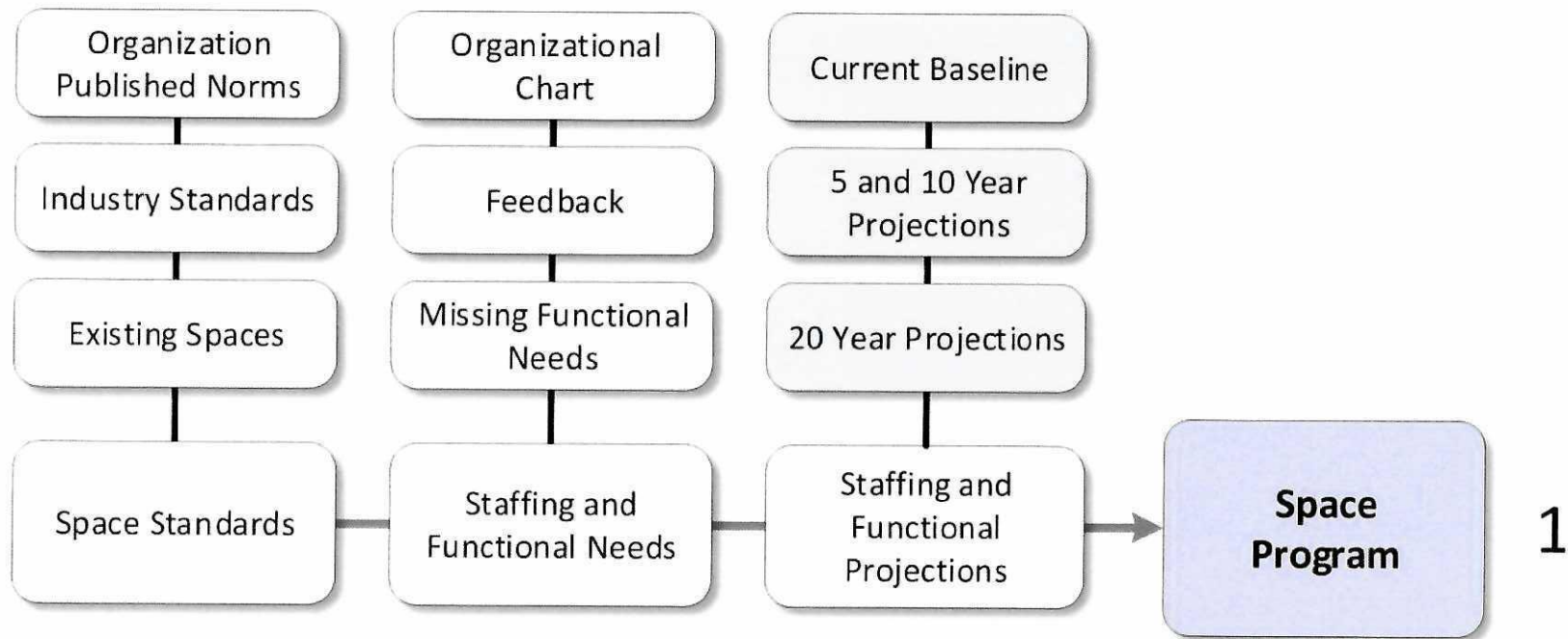



# Courtroom Planning

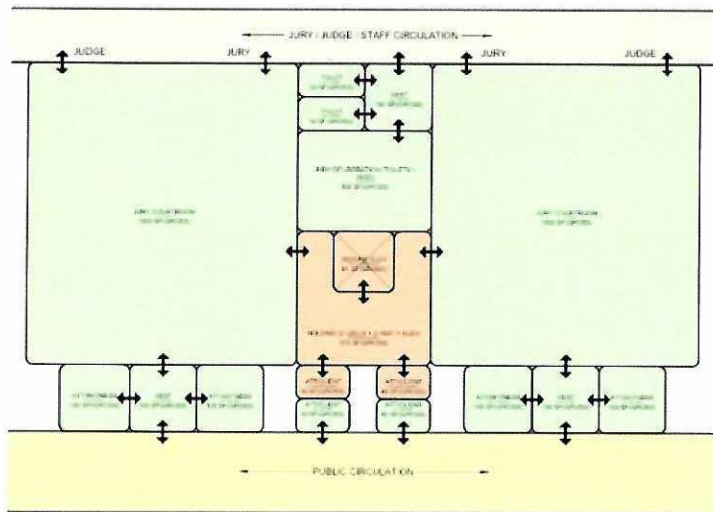

SPACE STANDARDS - COURTROOM SET  
3/32" = 1'-0"

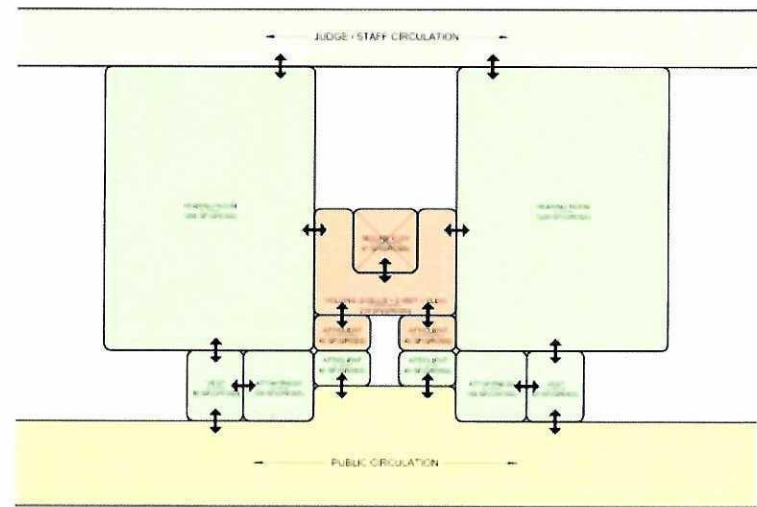

SPACE STANDARDS - HEARING ROOM SET  
3/32" = 1'-0"

# Staffing and Functional Needs

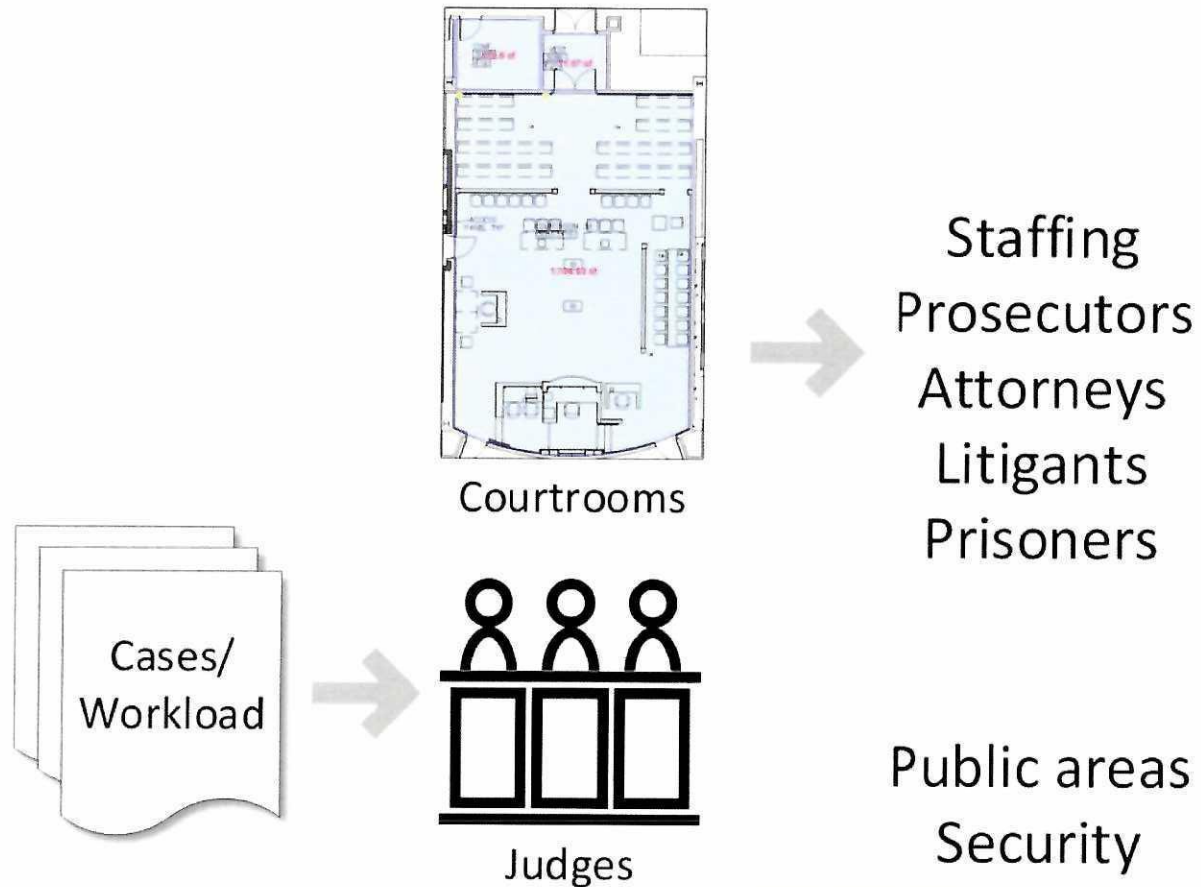

# Population Growth

Tulsa County, OK Population

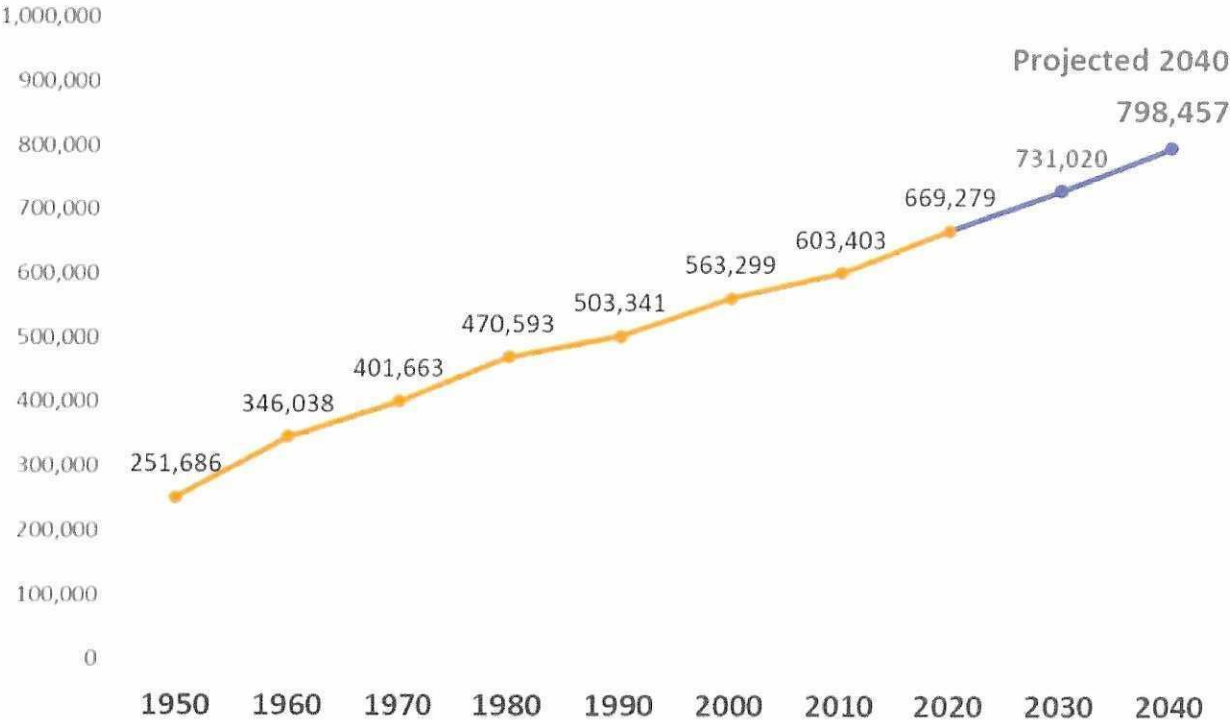



# Criminal Case Load

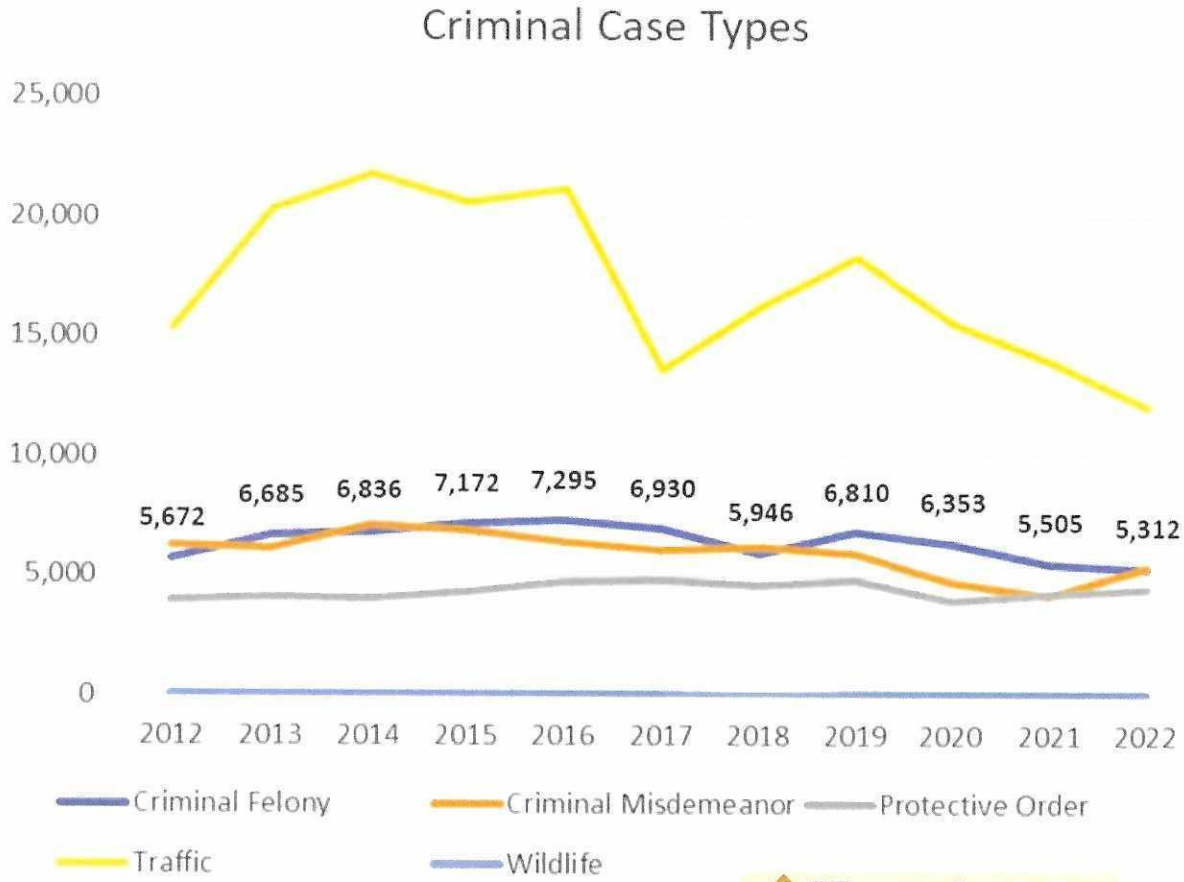

# Judge Projections

## District Court Judges Projections

Division	2023 Judges	2028 5-Years	2033 10-Years	2043 20-Years	Delta
Civil Division	8	8	8	8	0
Criminal Division	11	12	13	14	3
Family Division	7	7	7	7	0
Probate Division	3	4	5	6	3
<b>Courthouse Total</b>	<b>29</b>	<b>31</b>	<b>33</b>	<b>35</b>	<b>6</b>
Juvenile Division	4	4	4	4	0
<b>Total District Court</b>	<b>33</b>	<b>35</b>	<b>37</b>	<b>39</b>	<b>6</b>

District and Special Judges - Tulsa Courthouse 2023 29

Juvenile and Small Claims Judges - Juvenile Bureau 4

# Courthouse Staff Projections

## Court Clerk and Courthouse Staff Projections

Agency / Department	2023	2028 5-Years	2033 10-Years	2043 20-Years	Delta
Elected Clerk	1	1	1	1	0
Clerk's Office	145	155	161	171	26
Court Administration	4	4	4	4	0
Court Services	27	31	36	40	13
Alternative Courts	13	20	24	32	19
<b>Courthouse Total</b>	<b>190</b>	<b>211</b>	<b>226</b>	<b>248</b>	<b>58</b>

*Tulsa County Space Program Study*



# Space Program Functions and Departments

Courthouse Summary		2022 Staffing	2023 - Exist	
Space No.	Type		NSF	DGSF
0.000	<b>Tulsa County Court House</b>			
1.000	<u>Public Lobby</u>	0	2,240	3,136
2.000	<u>Divisions - Courtsets + Chambers</u>	98	89,216	124,902
3.000	<u>Court Administration</u>	4	12,250	17,150
4.000	<u>Clerk's Office</u>	146	13,476	18,866
5.000	<u>District Attorney's Office</u>	89	15,550	21,770
6.000	<u>Public Defender</u>	76	11,880	16,632
7.000	<u>Alternative Courts Program</u>	13	2,510	3,514
8.000	<u>Court Services</u>	27	5,060	7,084
9.000	<u>Law Library</u>	2	2,436	3,410
10.000	<u>Building Support</u>	0	6,780	9,492
11.000	<u>Building Parking</u>	0	12,250	17,150
12.000	<u>Prisoner Holding</u>	0	5,578	7,809
0.000	<b>Total Departmental GSF*</b>	455	179,226	243,107
	Building gross multiplier			1.15
0.000	<b>Total Building Gross Area BGSF**</b>			279,573

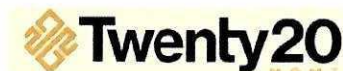

# District Court Courtrooms – Criminal Division

Court Divisions*		2023 Staffing	Space Standard SF	2023 - Exist		2028 - 5 Yr		2033 - 10 Yr		2043 - 20 Yr		Courthouse Summary
Space No.	Type			Units	SF	Units	SF	Units	SF	Units	SF	Notes
<b>2.000 Court Divisions</b>												
<b>2.200 Criminal Division (11 + 3 Judges)</b>												
2.201	Criminal Division Jury Trial Courtroom		1,850	11	20,350	12	22,200	13	24,050	14	25,900	Includes Chief Judge
2.202	Entrance Vestibule		150	11	1,650	12	1,800	13	1,950	14	2,100	1 per courtroom
2.203	Attorney/Client Conference Room		200	16	3,200	18	3,600	20	4,000	21	4,200	Approx. 1.5 per courtroom
2.204	AV Support Closet		100	6	600	6	600	7	700	7	700	Shared 1 per 2 courtrooms
2.205	Evidence Closet		112	6	672	6	672	7	784	7	784	1 per courtroom
2.206	Holding Cell		80	6	480	6	480	7	560	7	560	Shared 1 per 2 crim courtrooms
2.207	Holding Vestibule		180	6	1,080	6	1,080	7	1,260	7	1,260	Shared 1 per 2 crim courtrooms
2.208	Jury Deliberation Room		380	6	2,280	6	2,280	7	2,660	7	2,660	Shared 1 per 2 courtrooms
2.209	Jury Deliberation Toilet		50	12	600	12	600	14	700	14	700	2 per jury deliberation - M/W
2.210	District Judges Chamber	5	350	5	1,750	5	1,750	5	1,750	5	1,750	Includes Chief Judge
2.211	Special Judges Chamber	6	350	6	2,100	7	2,450	8	2,800	9	3,150	Private office
2.212	Bailiff	11	96	11	1,056	12	1,152	13	1,248	14	1,344	1 per judge, wkstn
2.213	Court Reporter	11	96	11	1,056	12	1,152	13	1,248	14	1,344	1 per judge, wkstn
2.214	Judges Toilet		50	11	550	12	600	13	650	14	700	In judges' chambers
2.215	Reception		72	6	432	6	432	7	504	7	504	Shared reception
2.216	Filing and Storage		60	6	360	6	360	7	420	7	420	1 per 2 judges, shared
<b>Staffing - Net Area (NSF)</b>		<b>33</b>	<b>4,176</b>	<b>33</b>	<b>38,216</b>	<b>36</b>	<b>41,208</b>	<b>39</b>	<b>45,284</b>	<b>42</b>	<b>48,076</b>	

# Tulsa County Courthouse

## Tulsa County Court House

Courthouse Summary		2022	2023 - Exist		2028 - 5 Yr		2033 - 10 Yr		2043 - 20 Yr		20 Year	Notes
Space No.	Type	Staffing	NSF	DGSF	NSF	DGSF	NSF	DGSF	NSF	DGSF	Delta	
<b>0.000</b>	<b>Tulsa County Court House</b>											
1.000	Public Lobby	0	2,240	3,136	2,240	3,136	2,640	3,696	2,640	3,696	560	18% increase
2.000	Divisions - Courtsets + Chambers	98	89,216	124,902	94,550	132,370	101,000	141,400	106,134	148,588	23,685	Increase of six judges in 20 years
3.000	Court Administration	4	12,250	17,150	12,250	17,150	12,250	17,150	12,250	17,150	0	No increase
4.000	Clerk's Office	146	13,476	18,866	14,260	19,964	15,044	21,062	15,828	22,159	3,293	17% increase
5.000	District Attorney's Office	89	15,550	21,770	16,250	22,750	17,050	23,870	18,378	25,729	3,959	Attorney and staff increase per judge
6.000	Public Defender	76	11,880	16,632	12,544	17,562	13,438	18,813	14,332	20,065	3,433	Attorney and staff increase per judge
7.000	Alternative Courts Program	13	2,510	3,514	4,060	5,684	4,860	6,804	6,260	8,764	5,250	Increase from 1 to 4 courtrooms
8.000	Court Services	27	5,060	7,084	5,500	7,700	5,940	8,316	6,380	8,932	1,848	Alternative Courts and EMP increases
9.000	Law Library	2	2,436	3,410	2,436	3,410	2,436	3,410	2,436	3,410	0	No increase
10.000	Building Support	0	6,780	9,492	6,780	9,492	6,780	9,492	6,780	9,492	0	No increase
11.000	Building Parking	0	12,250	17,150	12,950	18,130	14,000	19,600	15,050	21,070	3,920	Increase based on judges
12.000	Prisoner Holding	0	5,578	7,809	5,578	7,809	5,578	7,809	5,578	7,809	0	No increase
<b>0.000</b>	<b>Total Departmental GSF*</b>	<b>455</b>	<b>179,226</b>	<b>243,107</b>	<b>189,398</b>	<b>257,348</b>	<b>201,016</b>	<b>273,613</b>	<b>212,046</b>	<b>289,055</b>	<b>45,948</b>	
	Building gross multiplier			1.15		1.15		1.15		1.15	1.15	
<b>0.000</b>	<b>Total Building Gross Area BGSF**</b>			<b>279,573</b>		<b>295,950</b>		<b>314,655</b>		<b>332,413</b>	<b>52,840</b>	
						6%		13%		19%		Percentage increase from 2023



# District Court Summary

Existing Tulsa County Court (1953 building)	186,476 s.f.
Jordan Building	62,886 s.f.
<b>Total Existing Courthouse</b>	<b>249,362 s.f.</b>
<b>Space Program</b>	<b>332,413 s.f.</b>
Delta	83,051 s.f.

# Next Steps

- Final Report
- Block and Stack Diagrams
- Site Review
- Cost Review

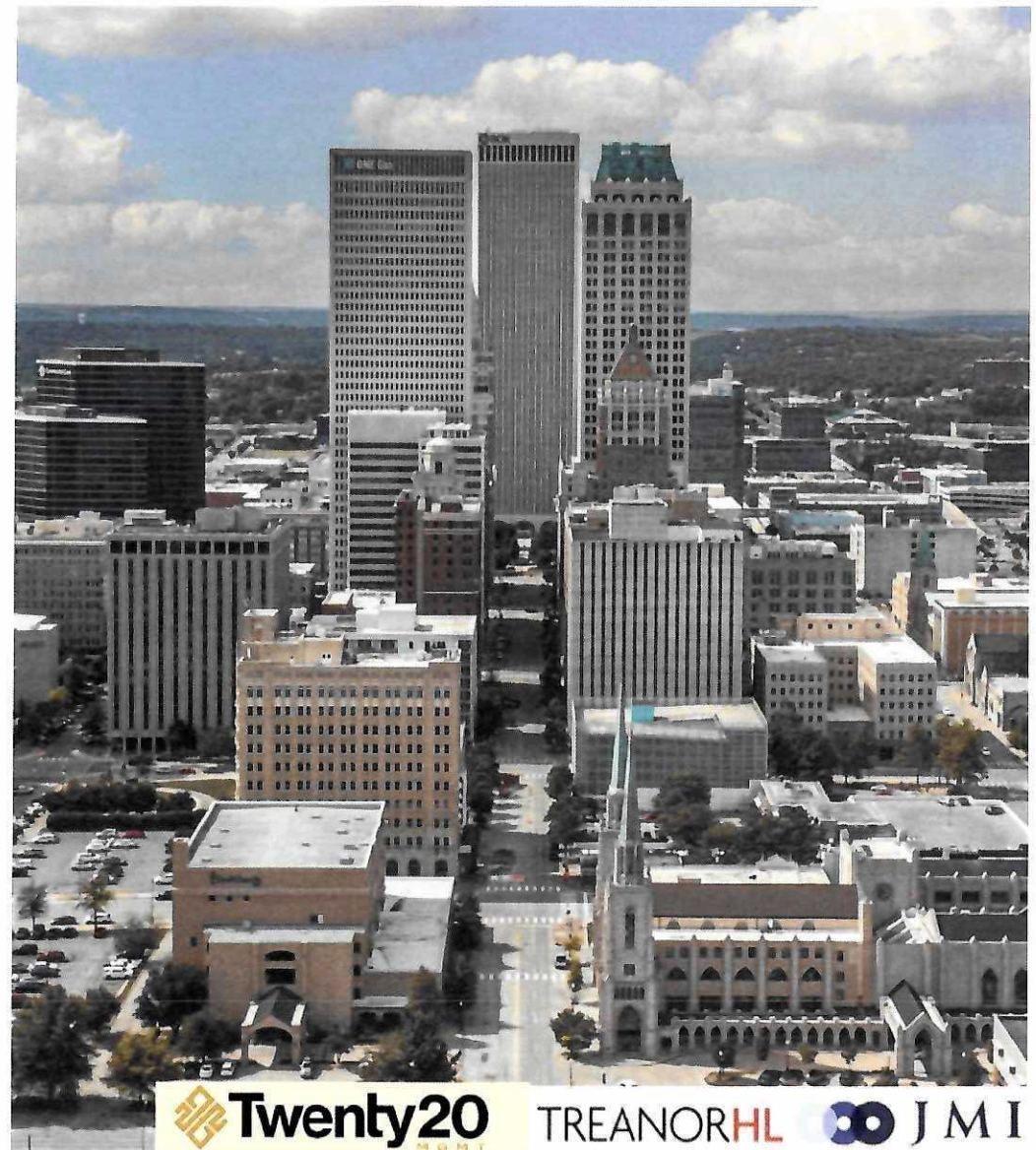



A scenic view of a park with a stone wall, a stream, and a city skyline in the background. The sky is blue with some clouds. The city skyline includes several tall buildings, one of which is a prominent skyscraper. The park features a stone wall, a stream, and various trees and plants.

# Questions?

 **Twenty20**  
PROFIT

TREANORHL   J M I